

Key Features of this Holiday Home

- ✓ Vaulted ceilings and large windows throughout
- ✓ Spacious, open plan layout
- ✓ Modern, shaker-style kitchen with solid oak worktops
- ✓ High-quality integrated appliances, incl. 4-burner gas hob, oven, fridge-freezer, dishwasher & washer/dryer
- ✓ En-suite bathroom to master bedroom
- ✓ Dining table and chairs
- ✓ Utility cupboard
- ✓ Large decking with stunning sea views

Benefits of Ownership

- 🔑 Simple 'turnkey' holiday home ownership
- 👤 NO stamp duty to pay
- 🔍 NO legal fees to pay
- £ A range of financing options including equity release, part-exchange and hire purchase
- 👥 Fully managed letting service available
- 📅 Holiday at any time of year with no closed season



The Sea Breeze
44 x 16 | 2 Bedrooms

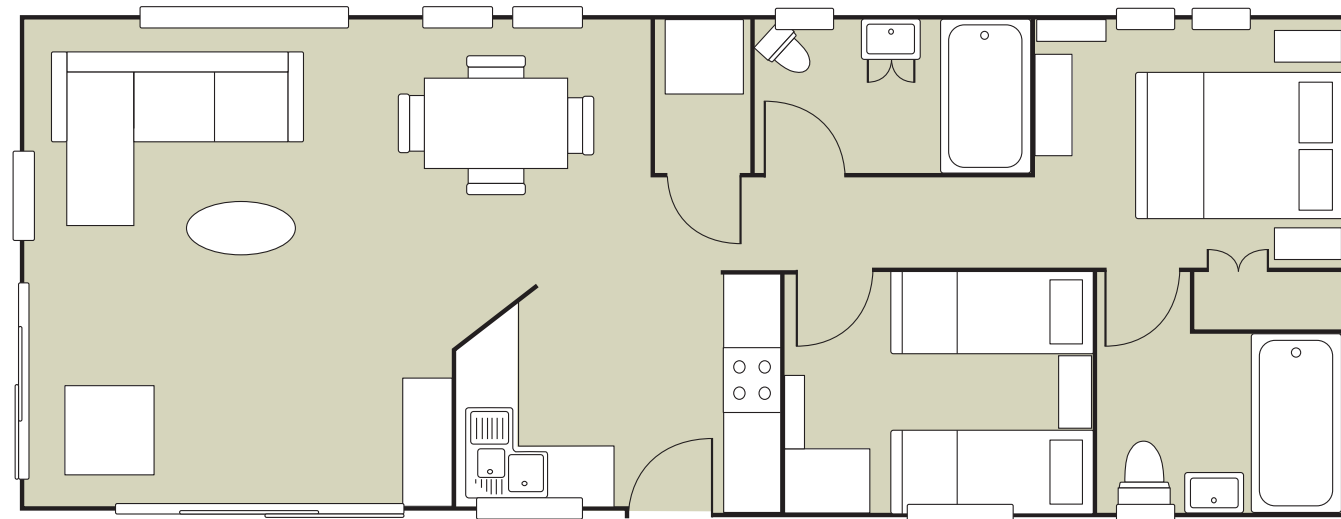

For more information, or to arrange your personal viewing appointment, please call Jeremy on **01726 843 425** or email: jeremy.reuben@swholidayparks.co.uk

Important notice: These particulars do not form part of any offer or contract and must not be relied upon as statements or representations of fact. Any areas, measurements or distances are approximate. The text, photographs and plans are for guidance only and are not necessarily comprehensive.

All accommodation at Seaview Gorran Haven is sold for HOLIDAY USE ONLY and must not be used as a primary place of residence. Evidence of a permanent address is required before purchasing and on-going annual checks of your permanent home address are a compulsory requirement of ownership.



The Sea Breeze

44 x 16 | 2 Bedrooms
Sealawns

southwestholidayparks.co.uk
01726 843 425

Welcome to the Sea Breeze

Offering perfect beach house vibes to complement our stunning coastal views, the incredible Sea Breeze lodge boasts open plan living with a subtle ocean theme throughout.

Crisp, white panelled walls and splashes of pastel watercolour tones enhance the spacious natural beauty, while large windows and twin patio doors create a light, open concept of everlasting elegance – perfect for relaxing in style and comfort whilst enjoying the panoramic sea views.

Further enhanced by an incredibly thoughtful layout, the Sea Breeze design offers both style and functionality; from the spacious shaker-style kitchen to fitted wardrobes – every element has been carefully selected. With a shower en-suite to the master bedroom, spacious dining area and a large L-shaped sofa, there's plenty of room for the whole family.

The perfect escape from routine life, the Sea Breeze lodge has it all.



Lodge Location

Our stunning Sea Breeze lodge is situated on an enviable plot on our Sealawns development. With a large decking area complete with glass balustrading, this luxury lodge is perfect for soaking up the unspoilt views of the South Cornwall coast. The Sea Breeze also benefits from a double-parking space and our 12-month holiday season means it can be enjoyed at any time of the year.

Why Choose Seaview Gorrans Haven?

Seaview Gorrans Haven is located centrally on the south Cornish coast, overlooking the ocean and the Roseland Peninsular, making it the perfect location to escape from the hustle and bustle of everyday life.

Seaview's secluded location doesn't mean that you're cut off from the host of local attractions nearby however; you're spoilt for choice when it comes to exploring the beauty of Cornwall. Enjoy an early morning jog down to the sandy beaches of Hemmick, discover the Lost Gardens of Heligan, Caerhayes Castle and the world-famous Eden Project or spend a leisurely day exploring the stunning villages of Gorrans Haven and Mevagissey just a short drive away.

As an Owner at Seaview, you'll also have full use of our five-star leisure facilities, including a heated outdoor swimming pool and dog-friendly park areas – so no matter the weather, you can enjoy your holiday home and its gorgeous location.









Hawthorne Lodges

Your Holiday Home Includes

-  Delivery, siting and all utilities connected
-  All kitchen appliances
-  High-quality freestanding furniture
-  Digital TV aerial and satellite connection
-  Manufacturer's Warranty
-  Large, low maintenance decking with glass front

Park Features & Benefits

-  5* VisitEngland graded park
-  Full 12-month holiday season
-  Stunning sea views
-  Outdoor heated swimming pool
-  Children's play areas
-  Complimentary golf at Carlyon Bay
-  Close to the South West Coast Path and beautiful sandy beaches

